

Replacing the Media for the Pelican NaturSoft NS3/NS6 Salt Free Water Softener/Conditioner

Parts List:

- 3 Litres (NS3) or 5 Litres (NS6) Scale Stop Media
- Funnel
- O-Ring
- Riser Tube Cap
- Silicone

The riser tube may or may not be fixed inside the tank depending on the model. Follow all the directions below if your model has a removable riser tube. If your model has a fixed riser tube, disregard the first note below and leave riser tube as-is.

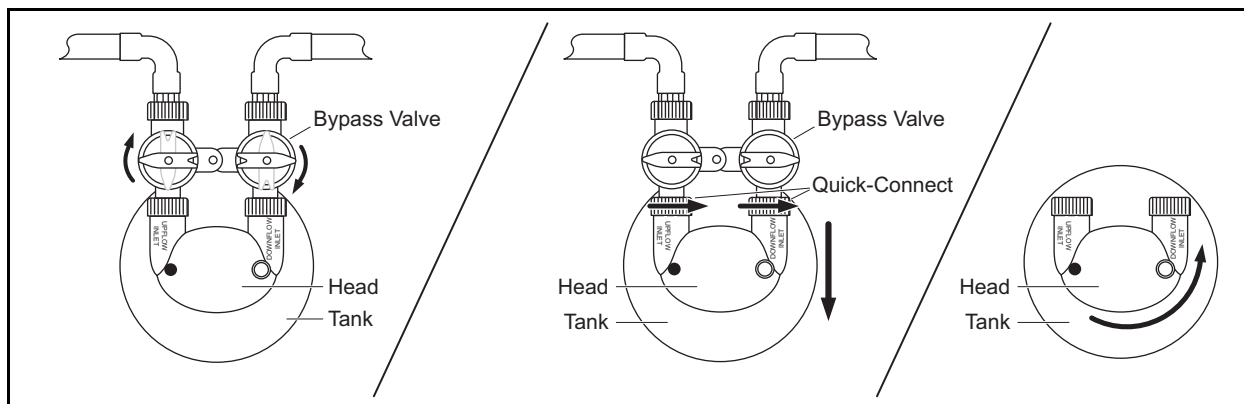

Figure 1

1. Turn the arrows on the Bypass Valve as shown to place the Bypass Valve into bypass mode.
2. Unscrew the Quick-Connects on the tank side of the Bypass Valve, leaving the Bypass Valve connected to the plumbing. Unscrew and remove the head from the tank.
3. Pour the expired NaturSoft media from the tank. It may be necessary to use a water hose to wash the wet media from the inside of the tank. Dispose of the expired NaturSoft media with normal household debris.

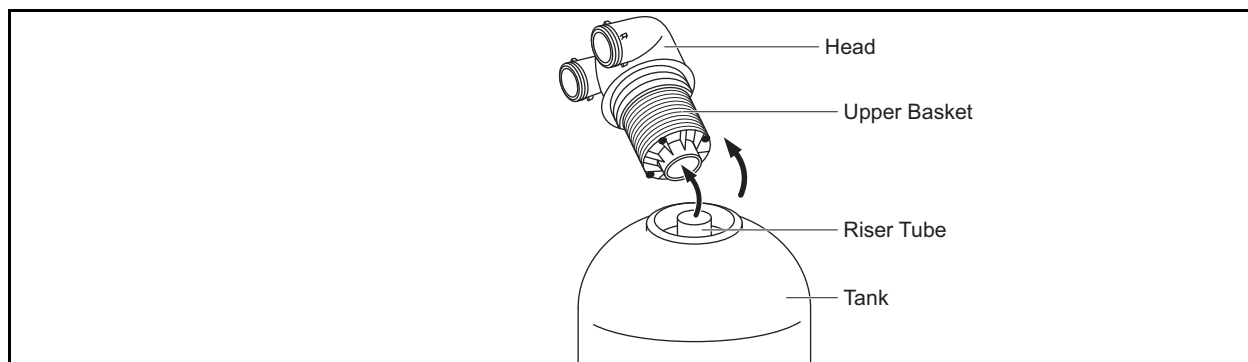

Figure 2

Note: If your tank has a removable riser tube, when removing the expired media from the tank the riser tube inside the tank will be flushed out of the tank along with the expired media. If this occurs, pull the tube all the way out and put it aside until the expired NaturSoft media is fully removed from the tank. If the riser tube does not come out during the above process, disregard this note and skip to step 5.

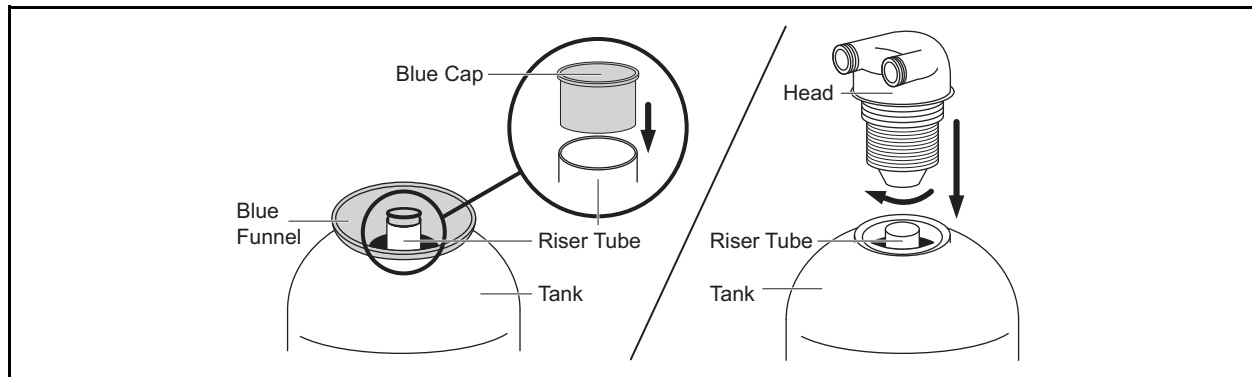

Figure 3

4. Once the expired media is removed, replace the riser tube inside the tank with the attached lower basket on the bottom and the open tube facing up.
5. The riser tube will rest in the center of the bottom of the tank. Cover the top of the riser tube with the provided blue cap then pour the Scale Stop Media and Gold KDF media replacement into the tank with the funnel provided.
6. Remove the blue cap from the end of the riser tube and fit the riser tube into the bottom of the upper basket attached to the head.
7. Push down to screw the head back onto the tank hand-tight.

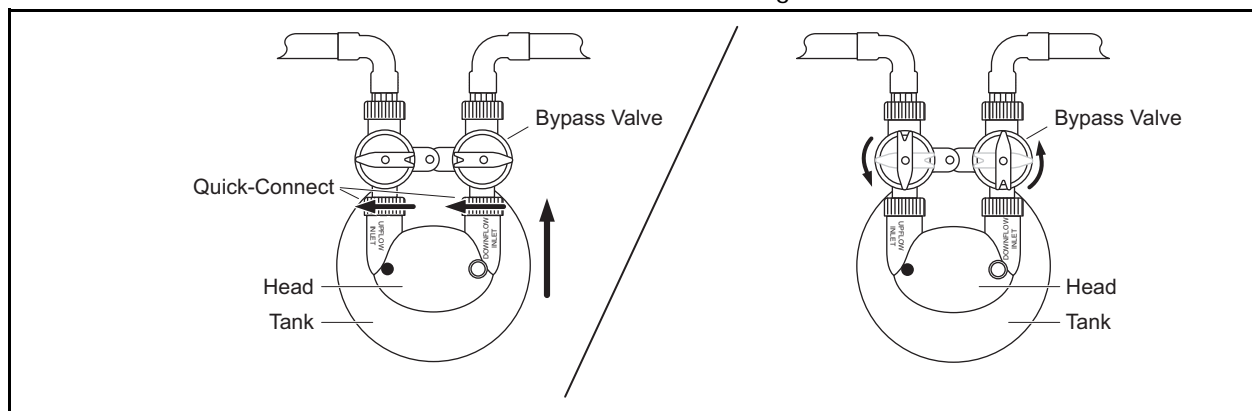

Figure 4

8. Install the tank head back onto the Bypass Valve hand-tight all the way to the tabs. Turn the arrows on the Bypass Valve back to their original positions.